

## WELCOME TO ZODIAC

Congratulations on your purchase from the Zodiac range of pool care products.

A trusted name in aeronautical and marine sectors, Zodiac now delivers its expertise to a full range of pools, automatic pool cleaners and water treatment systems.

Backed by world famous Baracuda technology, the Zodiac T5 Duo is your assurance of top quality in terms of design and performance.

All Zodiac products are designed so you can spend more time enjoying your pool and less on maintenance. The result is a simply sparkling pool.

## **IMPORTANT INFORMATION**

**YOU MUST READ THIS INFORMATION BEFORE INSTALLATION. ALWAYS READ THE OPERATION MANUAL BEFORE USING.**

**REMEMBER TO REGISTER YOUR WARRANTY WITHIN FOURTEEN (14) DAYS FROM DATE OF PURCHASE.**

## THIS KIT CONTAINS

Qty:	Description:
1	Zodiac T5 Duo machine head, complete with disc set
1	Hose protector mesh
12	Genuine Zodiac long life Twist-Lock Hose Section
1	Wheel Deflector
1	Blue hose weight
1	T5 Quick Connector
1	AD Flow Valve
1	Universal Weir Cuff
1	Pool Pulse

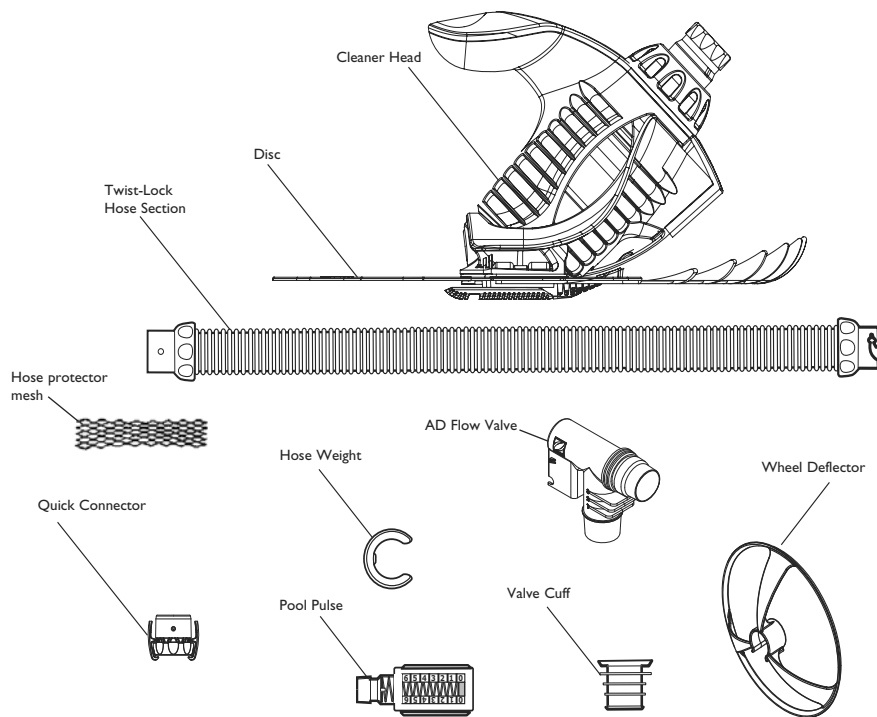

## **QUICK START INSTALLATION GUIDE**

	<b>PAGE</b>
<b>SECTION 1 – INSTALLATION</b>	<b>2</b>
<b>SECTION 2 – ACCESSORIES</b>	<b>7</b>
<b>SECTION 3 – CARE AND MAINTENANCE</b>	<b>8</b>
<b>SECTION 4 – POOL PULSE</b>	<b>12</b>
<b>SECTION 5 – PARTS DIAGRAM</b>	<b>13</b>
<b>SECTION 6 – TROUBLESHOOTING</b>	<b>14</b>
<b>SECTION 7 – WARRANTY INFORMATION</b>	<b>15</b>

## SECTION I – INSTALLATION

While the Zodiac T5 Duo is designed for easy assembly, some preliminary steps will assist the installation process.

Where possible, assembly should take place as close to the pool's skimmer box as possible.

### BEFORE YOU START

1. If your main drain is connected to the skimmer box, block off access.
2. Manually vacuum the pool.
3. Following manufacturer's instructions, clean the filter and empty the skimmer and the pump strainer basket.
4. Ensure circulation system is operating at maximum water flow, or you will need to re-adjust when it comes time to clean the filter and baskets.
5. Adjust the water flow, from all return inlets: –
  - (a) Downward and toward each other OR
  - (b) Downward and toward the centre of the pool.

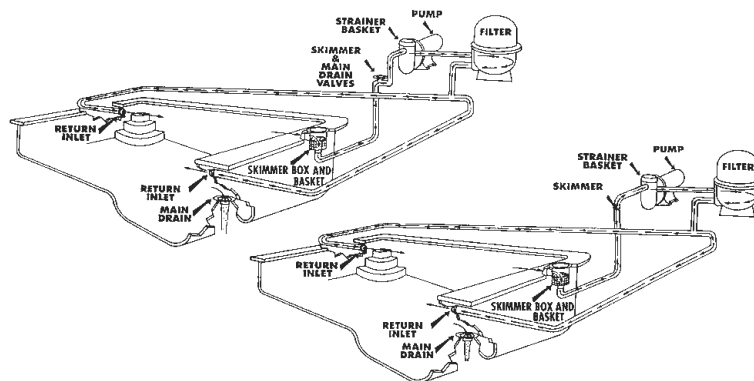

If return inlet directional fittings can't be directed far enough down to prevent water flow affecting the natural movement of the Zodiac hose, you will need to install Zodiac return line diverters. These are available from your local Zodiac dealer.

For pools with return inlet "eyeballs" face the inlets "eyeball" down.

## SECTION I – INSTALLATION

With your preparation complete, you are ready to begin installation.

If hoses are difficult to connect, soften and expand the plastic by dipping the end in a bucket of warm water.

1. Connect the first length of hose to the quick connector joint male cuff.

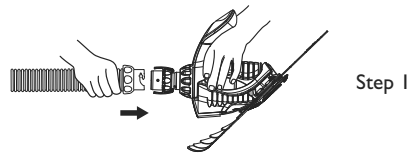

2. Push the quick connector joint onto the head of the cleaner, until it locks into place.

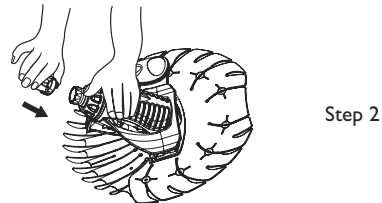

3. Clip the hose weight onto the end of your first length of hose (approximately 1 metre from the quick connector).

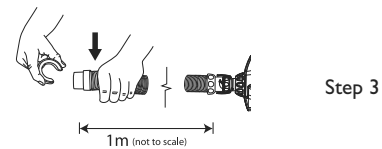

Submerging each length as you go, continue attaching hose lengths until you reach the required length for your pool. Use enough hose sections to reach the farthest point of the pool, then add another two (2) sections as shown in the diagram below.

The hose is now ready to be attached to the fittings in the skimmer box.

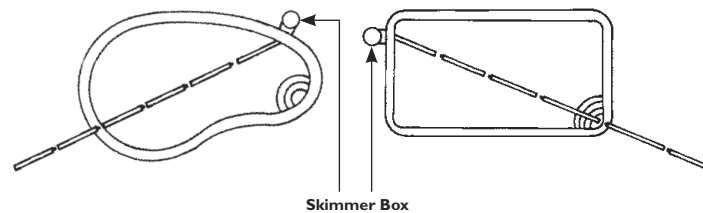

## SECTION I – INSTALLATION

### WHEEL DEFLECTOR

The Deflector ring can be used to help direct the T5 Duo around steps and other obstacles in the pool. Attach the ring by inserting the end of the cleaner hose through the outer ring and push the quick connector over the hose. Attach the ring just above the first hose cuff.

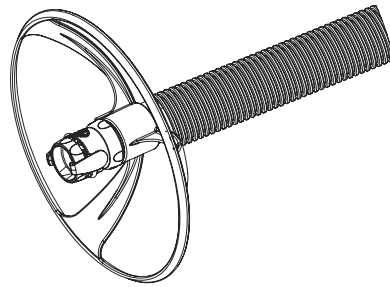

### CONNECT THE CLEANER

1. Submerge the cleaner and flood it with water.
2. When bubbles stop coming out of the extension pipe, connect the hose to the cleaner by pushing the quick connector onto the outer extension pipe until it locks into position with a clicking sound.
3. Allow the cleaner to drift to the bottom of the pool. Installation is complete. Turn on the pool pump and begin cleaning.

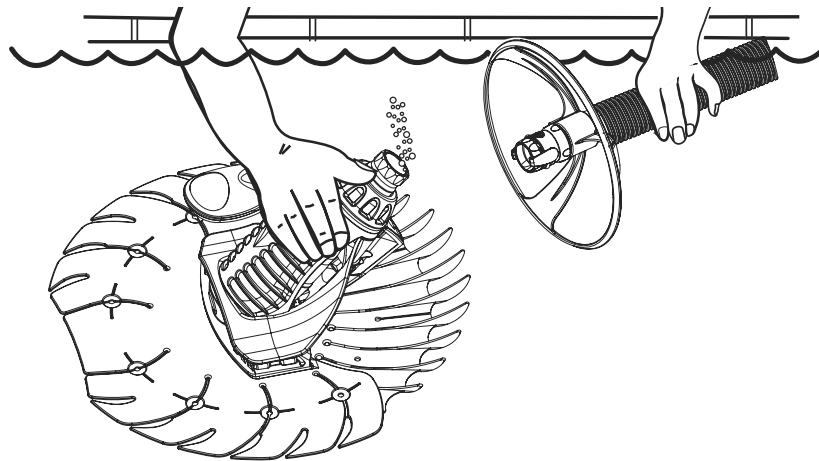

## SECTION I – INSTALLATION

### FINE TUNING CLEANER PERFORMANCE

The T5 Duo™ cycles on/off with the pool filtration pump vacuuming and cleaning all surfaces randomly throughout the pool. The coverage of the cleaner is dependent on the pool's shape and available water flow. In some applications, adjustments may be necessary to optimize cleaning coverage.

A properly balanced hose will create a 45° angle to the cleaner and the bottom of the pool.

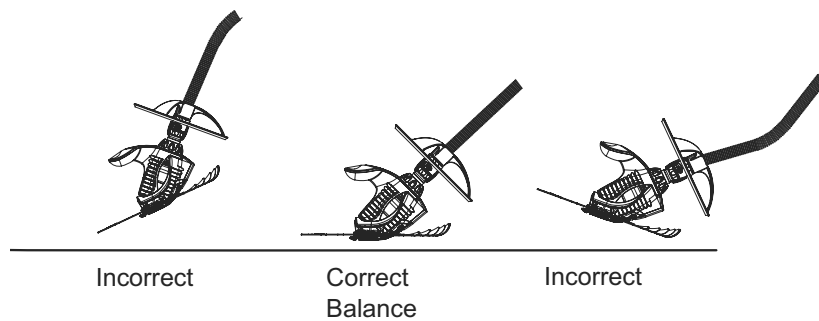

### POOL COVERAGE

While the return line water flow should not affect the natural movement of the hose, there are occasions where it can be beneficial.

Return line pressure can be used to balance cleaning coverage, and guide the cleaner away from steps and corners.

A return line located anywhere along the shaded area, can gently push the hose – allowing the unit to free itself from any in-pool obstacles.

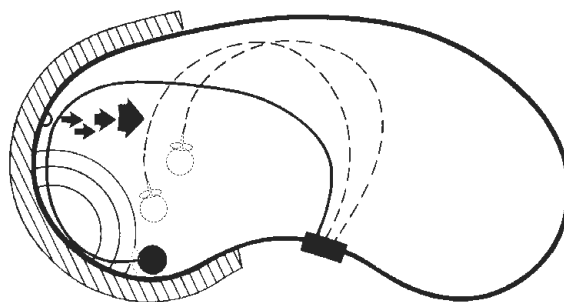

## SECTION I – INSTALLATION

### AD FLOW VALVE

The AD Flow Valve works by regulating the flow of water to the pump through the pool cleaner. As the filter collects debris, the valve automatically maintains the correct flow.

The use of the AD Flow Valve is recommended for:–

1. Pools with only one skimmer box/suction point.
2. Situations where the filtration system needs to be in operation, but the pool cleaner does not e.g. whilst the pool is in use.

The installation of the AD Flow Valve will depend upon the type of skimmer box. It is either installed from the top or the bottom of the skimmer. See below.

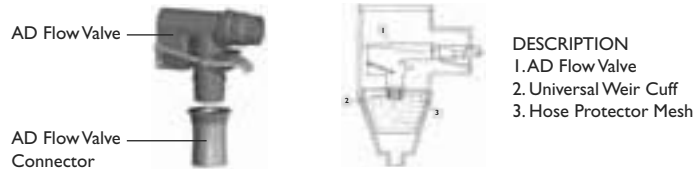

### WATERCO SKIMMER BOX

Screw in the AD Flow Valve connector from the top of the skimmer plate.



### POOLRITE SKIMMER BOX

Screw in the AD Flow Valve connector from the bottom of the skimmer plate.



### OTHER BRAND SKIMMER BOX

Insert the AD Flow Valve directly into the Weir Cuff.

### FACTORY SETTINGS

The AD Flow Valve has three settings. High (3) Medium (2) and Low (1).

To deliver maximum pool cleaning efficiency, the AD Flow Valve comes preset at a factory setting of 2.

You will only need to adjust the AD Flow Valve when and if a problem occurs.

### AD FLOW VALVE TROUBLE SHOOTING

PROBLEM	SOLUTION
The Zodiac Pool Cleaner is performing too fast and/or climbing above the level of the water.	Reduce AD Flow Valve to Setting 1
The Zodiac Pool Cleaner is performing slowly and/or is not climbing the pool walls.	Increase AD Flow Valve to Setting 3